



FLOW



Dual Chamber Orifice Fitting

Tek-DP 1610B

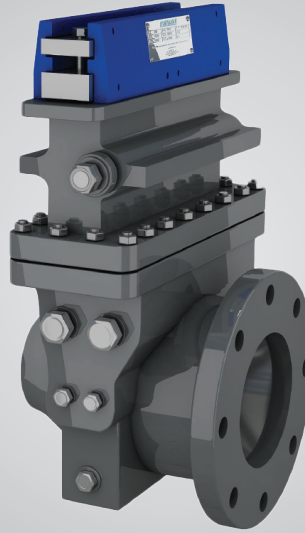

1 FEATURES

- Highly reliable and field-repairable
- Ensures fast and safe plate replacement
- Requires no breaking apart or depressurizing the flow line
- No operational downtime
- Eliminates liquid or gas leakage possibility
- Offers versatility of line sizes
- Option with Dual Isolation (DBB) complies with HSG253 publication for safe isolation of plant and equipment.

2 SPECIFICATION

Body materials	A216 WCB, A216 WCC, A352 LCC, A358 CF8M, A995 Gr4A, A995 Gr6A, Custom material available
Internal parts	AISI 4130 Carbon Steel, 316 or A351 Stainless Steel
Tap connections	Two ½" NPT per side standard, 4 pairs available as options
Fitting sizes and ANSI class	2" to 48", 150 to 2500 ANSI, Larger sizes available on request
Operating temperature	Standard -20 °F to 100 °F (-28 °C to 37 °C), optional -40 °F to 1200 °F (-40 °C to 648 °C)
Orientation	Vertical or horizontal
Process media	Liquids and Gases
Line bore I.D. tolerance	In conformance with AGA 3 and ISO-5167 Latest Edition
Eccentricity repeatability	In conformance with AGA 3 and ISO-5167 Latest Edition

3 APPLICATIONS

- Oil and gas custody transfers
- Water, wastewater treatment plants
- Gas distribution
- Chemically active and corrosive liquid transfers

CONTACT US

📍 796 Tek Drive, Crystal Lake, IL 60014 USA

☎ +1 847 857 6076

✉ Email: tektrol@tek-trol.com

🌐 www.tek-trol.com